

XEROX®

Technology | Document Management | Consulting Services

WorkCentre® 7228 / 7235 / 7245



print | copy | scan | fax | email

Amazing versatility...
with office color power



WorkCentre® 7228 / 7235 / 7245



Essential

Complete copying and exceptional network printing give your office the key functions you need.

Versatile

Customize with more powerful features and additional functionality.

Powerful office features

COPY

PRINT

COLOR

- **Fast walkup copying** with performance features and two-sided capability.
- **Network printing** meets large workgroup requirements for speed, efficiency and security.
- **Strategic color when you need it** – convenient and selectable on demand.

- **Add the power of scanning** to multiple destinations — including email, mailbox, PC Desktop, FTP and network servers — to streamline your workflow.
- **Internet fax, walkup fax, network server fax** capabilities increase efficiency and decrease cost.

SCAN

EMAIL

FAX

WorkCentre®

7228 / 7235 / 7245

One multi-tasking unit delivers the powerful features your business uses everyday: copying, network printing, email, fax, and scanning. The versatile Xerox solution protects your data and produces exceptional print quality – in black-and-white or color.

Powerful features to support every office need

Getting the job done these days requires every technological advantage you can get. This multifunction system provides the firepower a document-intensive company needs to keep all of its workgroups up to speed and up-to-date.

- All the traditional features of a robust black-and-white multifunction – plus the benefit of color.
- Tackle projects on multiple fronts. Users can simultaneously scan, print, copy, fax, and route files to their next destination to maximize productivity.

- Choose an array of fax tools and get cutting-edge features such as Fax Forward to Email. This feature not only offers you digital storage of faxed documents, it also provides a seamless way to integrate these documents into your digital workflows.
- Easily convert hard copy documents to electronic files and send them via email around the office or around the world.
- 1200 x 1200 dpi resolution and media sizes up to 12 x 18 in. deliver impressive quality for any office job.
- Remarkable detail, subtle half-tones and clarity of fine lines thanks to our latest Emulsion Aggregate High Grade toner.



Business benefits from color

- *Color can be a strategic advantage. Studies show that it dramatically increases motivation and response to sales messages, and that it makes businesses look more professional.*
- *Color adds impact to critical documents. Key information is easier to locate when highlighted in color and documents are read and remembered better.*

Easy access to powerful features

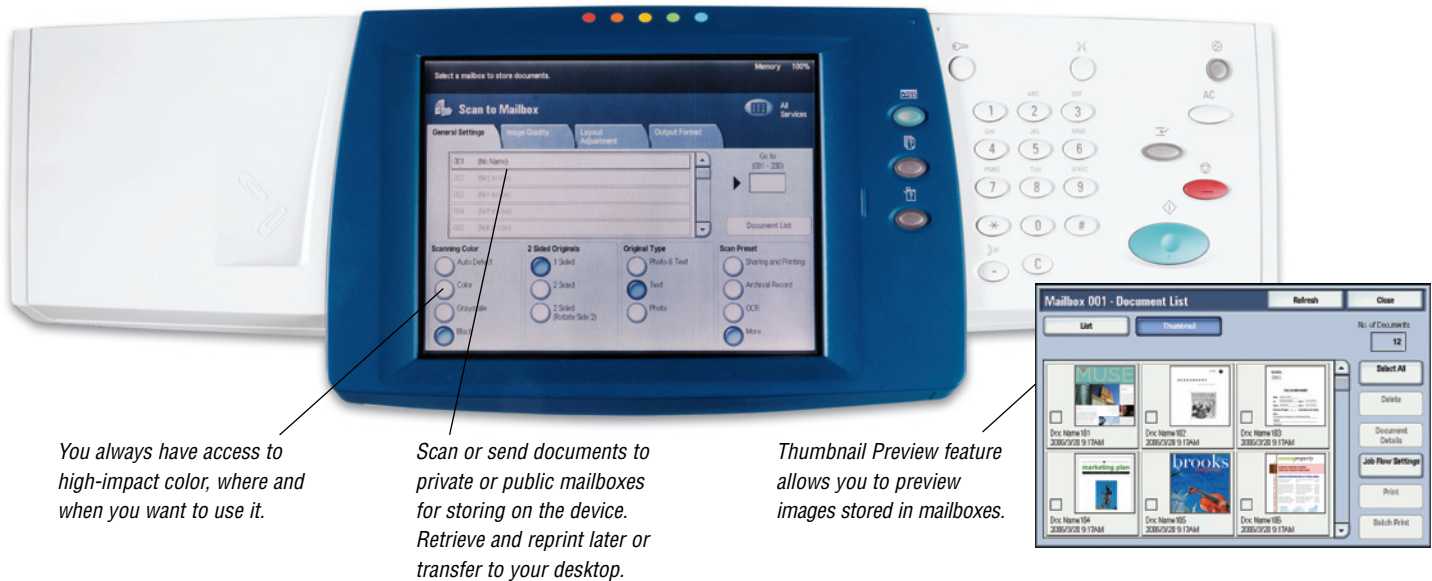

You always have access to high-impact color, where and when you want to use it.

Scan or send documents to private or public mailboxes for storing on the device. Retrieve and reprint later or transfer to your desktop.

Thumbnail Preview feature allows you to preview images stored in mailboxes.

Versatility to make your work easier

The WorkCentre 7228 / 7235 / 7245 integrates smoothly and easily into your office. We've loaded it with scanning, throughput and finishing tools that increase efficiency, save money, and create professional-looking documents.

- Scan to desktop, network file server, document management system, via template, email, fax, or almost any other destination with high-quality color, grayscale, or black-and-white.
- Internet and email network capabilities allow instantaneous delivery worldwide – efficiently and inexpensively.
- SMARTsend™ software converts, distributes and routes scanned documents to wherever they're needed, in whatever format required.
- Scan and store color documents as High Compressed PDF, optimizing file size and image quality, and minimizing network traffic.
- If you're printing or copying a lot, why keep reloading paper or switching media in the trays? Get the flexibility of five different input trays and 2,180-sheet or 3,140-sheet capacity.
- A wide range of media is supported – from heavyweight (up to 80 lb. Cover / 220 gsm) to 12 x 18 in. size.

Versatile Finishing Options

Produce professional documents in-house quickly and easily. Our wide range of finishers eliminate the effort and expense of collating, folding and stapling by doing it for you.

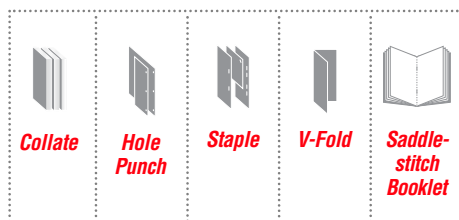

Office Finisher
multi-position stapling



Advanced Office Finisher
multi-position stapling,
hole-punch



Professional Finisher
multi-position stapling,
hole-punch, booklet
saddle-stitch, V-fold

Security at all points

Xerox is committed to helping you meet your security needs. Our system, software and solutions are designed with features that allow you to control the level of security that is right for your office.

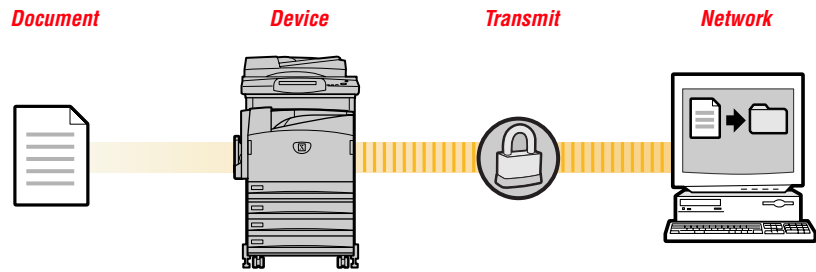

- Password Protected PDF
- Secure Watermark
- Secure Print
- Fax Security

- Image Overwrite
- Device Access Password Protection
- Encrypted Disk Drive
- Analog Fax and Network Isolation
- Audit Log

- Encrypted Scan to Email
- Password Protected PDF

- Network Authentication

Scaleable business solution

Manage and monitor your network devices with ease. And keep all your data safe. Thanks to the modular WorkCentre design, you can deploy and upgrade security tools that best meet the needs of your business.

- Xerox CentreWare® Internet Services software simplifies installation and network administration and provides quick access to device and job status, accounting information and other operational metrics.
- Built-in Web pages allow you to manage, configure and troubleshoot from anywhere using a Web browser.
- For enterprise-level printer management, server-based CentreWare® Web makes it easy to install, configure, obtain reports and troubleshoot all network devices, regardless of manufacturer.

- Smart Kit™ technology predicts and prevents potential problems, enhancing device management and giving you more of what you need most: uptime.
- Smart eSolutions offers hands-free, hassle-free, secure administration of Xerox devices for automatic meter reads and supply replenishment.
- Protect your hard copy with Secure Watermark. And encrypt any job stored on the device's hard drive.
- Digitally safeguard transmissions of sensitive documents by fax or email, including encrypted scan to email and password protected PDF.
- LDAP authentication for accessing information directories. Network Authentication controls device access using common network architectures such as Kerberos and SMB.
- Image Overwrite protection electronically "shreds" data stored on the hard drive during routine printing, scanning, copying or faxing, protecting your data.

Powerful cost management solutions

- Access to color options can be password-protected or granted to specific users or groups – you're in control of who uses it. Access to the entire device or specific functions can be limited by password or PIN.
- The Internal Auditor tracks usage of walk-up copy and print features.
- Xerox Standard Accounting (XSA) provides job-based accounting features for greater cost control of printing, copying, faxing and scanning.
- Usage reports can be downloaded from the device or over the network. These can be easily integrated with customized third-party accounting solutions.

Call today. For more information or detailed product specifications, call **1-800-ASK-XEROX**. Or visit us at **www.xerox.com/office**

Platen Cover Option

High Capacity Feeder Option

Duplex Automatic Document Feeder Option

Base Unit with One 520-sheet Paper Tray and Offsetting Catch Tray

Three Tray Option

Office Finisher

Advanced Office Finisher

Professional Finisher

CONFIGURATIONS		WorkCentre® 7228	WorkCentre® 7235	WorkCentre® 7245
Speed		Up to 28 black-and-white / 26 ppm color	Up to 35 black-and-white / 31 ppm color	Up to 45 black-and-white / 35 ppm color
Duty Cycle		Up to 135,000 images / month depending on model		
Paper Handling				
Paper Input	Standard	Bypass Tray: 100-sheets; Size: 4.13 x 5.83 in. to 12 x 18 in. / 105 x 148 mm to SRA3 Tray 1: 520-sheets; Size: 5.5 x 7.2 in. to 11 x 17 in. / 139.7 x 182 mm to A3		
	Optional	Duplex Automatic Document Feeder: 75 sheets (based on 80 gsm paper) Three Tray Option (Total 2,180 sheets): Adds three 520-sheet Paper Trays; Size: 5.5 x 7.2 in. to 11 x 17 in. / 139.7 x 182 mm to A3 High Capacity Feeder (Total 3,140 sheets): Adds one 520-sheet Paper Tray; Size: 5.5 x 7.2 in. to 11 x 17 in. / 139.7 x 182 mm to A3, one 800-sheet Tray and one 1,200-sheet Tray; Size: 8.5 x 11 in. / A4		
Paper Output	Standard	400-sheet Offsetting Center Catch Tray (200 sheets with any Finisher option)		
	Optional	Office Finisher: 1,000-sheet stacker, 50-sheet multi-position stapling Advanced Office Finisher: 3,000-sheet stacker and 500-sheet top tray, 50-sheet multi-position stapling and hole punch Professional Finisher: 1,500-sheet stacker and 500-sheet top tray, 50-sheet multi-position stapling and hole punch, saddle-stitch booklet maker, V-fold brochure maker		
Security		Fax Security, Secure Print, Image Overwrite Security, Secure Watermark, Password Protected PDF, Encrypted Disk Drive, and Email and Print Channel via SSL/TLS Encryption		
Accounting System		Internal Auditron – Xerox Standard Accounting – Copy, Print, Fax, Scan; Optional Job Based Accounting (3rd Party) 768 MB plus 40 GB hard drive		
First Page Out Time		As fast as 5.7 seconds black-and-white / 7.5 seconds color		4.8 seconds black-and-white / 7.2 seconds color
Copy Resolution		600 x 600 dpi		
Copy Features		Color touch screen interface, automatic two-sided, electronic pre-collation, automatic tray selection; build job, negative/mirror image, automatic booklet creation, multi-up, auto RE, mixed-size originals, auto registration, covers insertion, sample set, bound copying, store and recall job programming, annotation, auto color selection, area designation, poster mode, ID Card Copy		
Print Processor / PDL		600 MHz / Adobe® PostScript® 3™, PCL 5c and PCL 6 emulations		
Connectivity		10/100 BaseT Ethernet, 10Base2, 10Base5 (via adapter), USB (optional), Wireless Ethernet 802.11b (via third-party adapters), Parallel		
Print Resolution		600 x 600 dpi, 1200 x 1200 dpi		
Print Features		Secure print, delay print, sample set, booklet creation, cover selection, paper selection by attribute, multi-up, watermark, annotation, banner sheets, poster, fit to new paper size, transparency interleave, output tray selection, store and recall driver settings, color balance and controls		
Fax	Optional	Walk-Up Fax (one-line and three-line options), Internet Fax, Fax from Print Driver		
Fax Features		Fax Forward to Email, Mailbox, Duplex Send and Receive, print on fax up to 11 x 17 / A3, Fax Build Job, Fax Bound Originals, Network Server Fax*		
Scan	Optional	Scan-to-Email, Scan to PC Desktop, Scan to Mailbox, Scan to FTP, Thumbnail Preview, High Compression PDF, Various Xerox Business Partner Solutions, SMARTsend		
Scan Features		PDF, JPEG, TIFF, Multi-page TIFF, Mixed Size Originals, Scan Build Job, Auto Color, XPS		
Other Options		Foreign Device Interface, Media Card Reader		

* Network Fax Server requires scan enablement.

More integrated value-added solutions

Flexible, open architecture allows easy integration with leading third-party software developers. An array of Xerox Business Partner solutions are available to enhance the functionality of your Xerox multifunction system, including:

- Faxing. Integrate network fax capabilities, including desktop control, to increase your efficiency and save money.
- Accounting. Streamline and digitize processes such as billing, identify savings opportunities, find new sources of value, and simplify work processes.
- Scanning. Provide digital safeguarding to allow scan and secure transmission of highly sensitive documents by fax or email.



© 2006 XEROX CORPORATION. All rights reserved. XEROX® and WorkCentre® are trademarks of or licensed to XEROX CORPORATION. In support of Xerox's environmental leadership goals, these models may contain some recycled components that are reconditioned. Adobe, PostScript®, and PostScript 3 are either registered trademarks or trademarks of Adobe Systems Incorporated in the United States and/or other countries. PCL® is a registered trademark of Hewlett-Packard Company. Product information and/or specifications are subject to change without notice. 3/07 610P725950C W72BR-01UD